

**Serie | 4, Washing machine, front loader, 7 kg, 1400 rpm
WAN28081GB**



**Automatic washing machine with
EcoSilence Drive™: quiet operation and
durability that you can rely on.**

- **EcoSilence Drive™:** quiet and energy-efficient drive, with a 10-year warranty.
- **SpeedPerfect:** perfectly clean in up to 65% less time*.
- Easy-to-use LED display with touch control and many additional functions like start delay and remaining time.
- **Reload function:** forgot an item? Add it easily to the wash.
- **AntiVibration™ Design:** extremely stable and especially quiet thanks to special vibration protection.

Technical Data

Energy Efficiency Class: D
 Weighted energy consumption in kWh per 100 washing cycles of eco 40-60 programme: 69 kWh
 Maximum capacity in kg: 7.0 kg
 The water consumption of the eco programme in liters per cycle: 45 l
 Duration of eco 40-60 programme in hours and mins at rated capacity: 3:20 h
 Spin-drying efficiency class of eco 40-60 programme: B
 Airborne acoustical noise emission class: B
 Airborne acoustical noise emissions : 75 dB(A) re 1 pW
 Construction type: Free-standing
 Height of removable worktop: -2 mm
 Dimensions of the product: 848 x 598 x 550 mm
 Net weight: 68.3 kg
 Connection rating: 2300 W
 Fuse protection: 10 A
 Voltage: 220-240 V
 Frequency: 50 Hz
 Approval certificates: CE, E17D UKCA marking, VDE
 Length of electrical supply cord: 210 cm
 Door hinge: Left
 Wheels: No
 EAN code: 4242005221868
 Installation type: Free-standing

Optional accessories

WMZ2200 : Floor securing component
 WMZ2381 : Extension for cold water inlet /Aquastop



4 242005 221868

**Serie | 4, Washing machine, front loader, 7 kg, 1400 rpm
WAN28081GB**

Automatic washing machine with EcoSilence Drive™: quiet operation and durability that you can rely on.

Performance

- Energy Efficiency Class¹: D
- Energy² / Water³: 69 kWh / 45 litres
- Load capacity: 1 - 7 kg
- Programme duration⁴: 3:20 h:min
- Spin drying efficiency class: B
- Spin speed^{**}: 400 - 1400 rpm
- Noise level: 75 dB (A) re 1 pW
- Noise efficiency class: B

Programmes/functions

- Touch control buttons: Ready in, SpeedPerfect, start/pause with reload function, Spin speed reduction
- Special programmes: Rinse, Mixed Load, Super Quick 15/30, Handwash/Wool, Delicates 30°C
- Safeguard monitoring system adjusts load distribution and programme settings to protect clothes

Key features

- Fully electronic control dial for all wash and special programmes
- SpeedPerfect: perfectly clean in up to 65% less time.
- Reload function: Flexibility to add or remove laundry items of any size even after start of the wash cycle.
- EcoSilence drive with 10 year warranty
- AntiVibration Design - for more stability and quietness

Additional features

- Large display for programme progress indication, spin speed, remaining time, 24 hour end time delay and load recommendation.
- 3D AquaSpa wash system with cascade for faster water penetration
- Multiple Water Protection
- Foam detection system
- Divider for Liquid Detergent
- Child lock
- Buzzer to indicate the end of cycle

Technical Information

- Slide-under installation
- Drum volume: 55 litres
- Large silver-white door with 180° opening and 30 cm porthole
- Dimensions (H X W X D): 84.8 x 59.8 x 60 cm

¹ Scale of Energy Efficiency Classes from A to G

² Energy consumption in kWh per 100 cycles (in programme Eco 40-60)

³ Weighted water consumption in litres per cycle (in programme Eco 40-60)

⁴ Duration of Eco 40-60 programme

^{**} Values are rounded.

**Serie | 4, Washing machine, front loader, 7
kg, 1400 rpm
WAN28081GB**

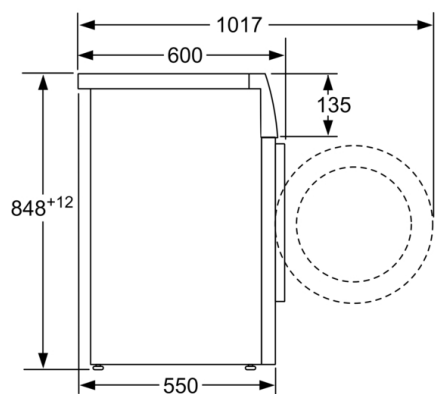

measurements in mm

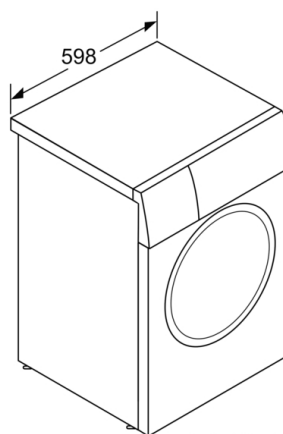

measurements in mm